

APPLICATION INSTRUCTIONS - CreteProof Swell 2010

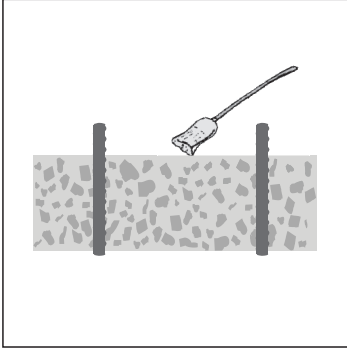

Step 1:
Clean Surface from dust,
dirt and loose particles.

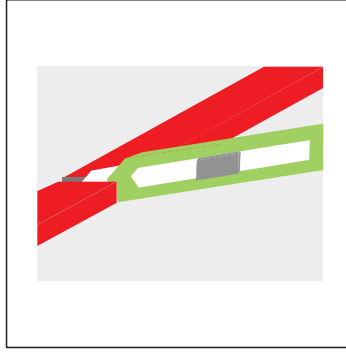

Step 2:
Cut the swelling gasket with knife
to desired length.

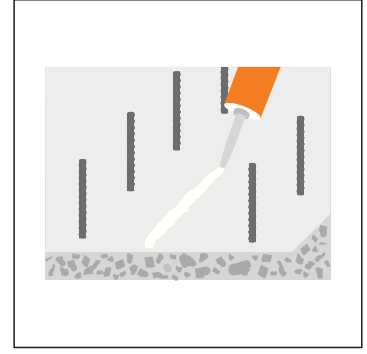

Step 3:
Apply adhesive (CreteSeal PU 25) to
concrete or swelling gasket.

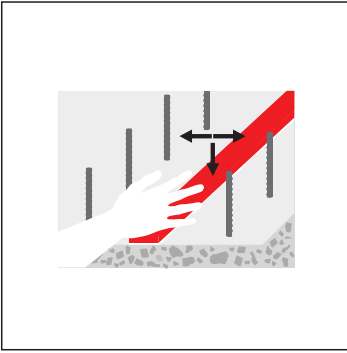

Step 4:
Press gasket evenly into
adhesive, do not stretch.

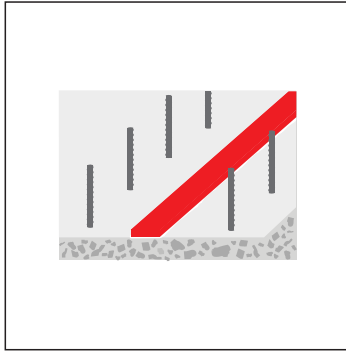

Step 5:
Butt joint for the connection of
gaskets. Coverage minimum 8 cm.

Details

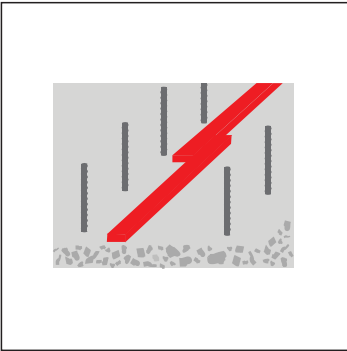

Overlapping

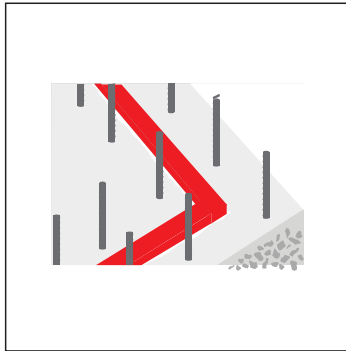

Horizontal Corner Connection

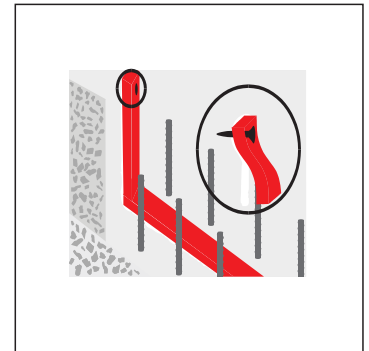

Horizontal Vertical Corner Connection

Precautions

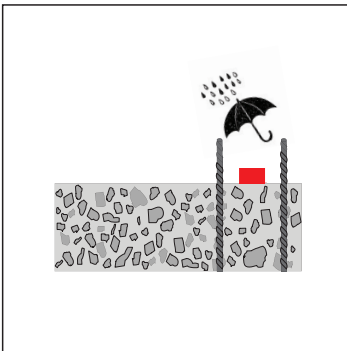

Protect swelling gasket from wet and dirt

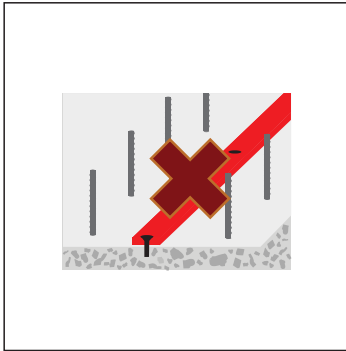

Mechanical application is not recommended.



EGECRETE

EGECRETE Yapı Kimyasalları A.Ş.
A licensee of EUCLID CHEMICAL

Merkez/Headquarters: Ayazma Cad. No: 37 Papirus Plaza Kat:10 Kağıthane 34406 İSTANBUL-TÜRKİYE Tel/Phone: +90 212 2946567
Fabrika-Depo/Plant-Warehouse: Asagi Kirazca Mah.Okul Sokak No:17 Arifiye 54580 SAKARYA-TÜRKİYE Tel/Phone: +90 264 2293200
satis@egecrete.com - www.egecrete.com

UYGULAMA TALİMATLARI - CreteProof Swell 2010

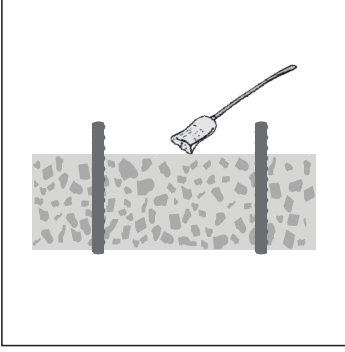

1. Aşama:
Yüzeydeki toz, kir ve zayıf parçaları temizleyiniz.

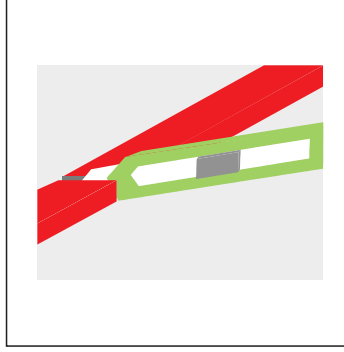

2. Aşama:
Şişen bandı kesici yardımıyla istenen uzunlukta kesiniz.

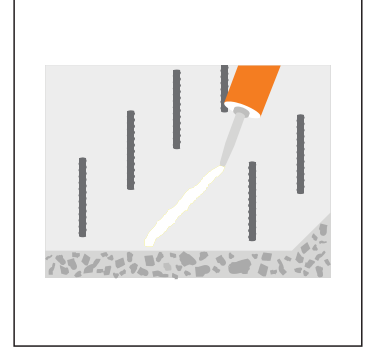

3. Aşama:
Yapıştırıcı (CreteSeal PU 25) beton yüzeyine ya da şişen banda uygulayınız.

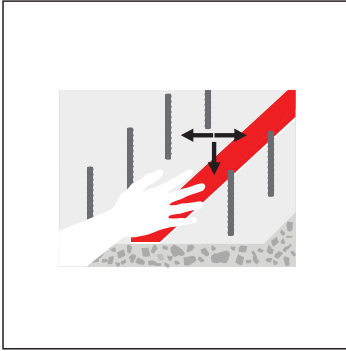

4. Aşama:
Şişen bandı yapıştırıcıya doğru eşit şekilde bastırınız, germemeye özen gösteriniz.

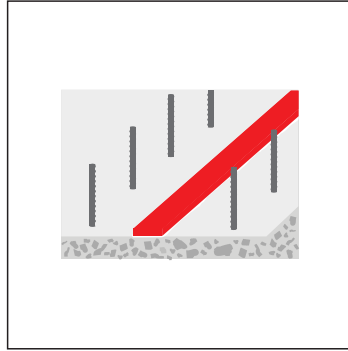

5. Aşama:
Şişen bandın bitiş noktasına doğru bağlantısı minimum 8 cm olmalıdır.

Detaylar

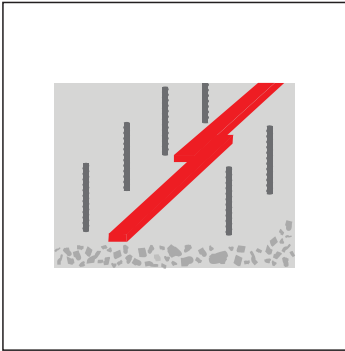

Bindirme detayı

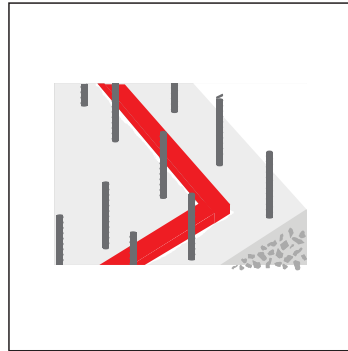

Yatay Köşe Bağlantısı

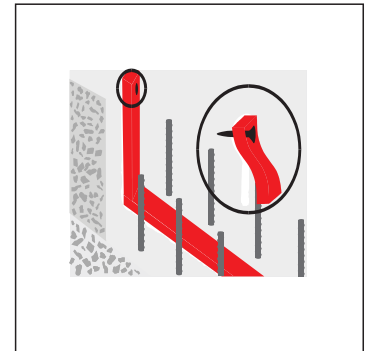

Yatay Dikey Köşe Bağlantısı

Uyarılar

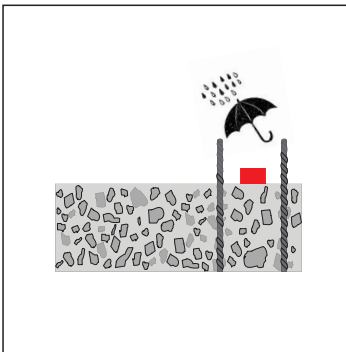

Şişen bandı sudan ve kirden koruyunuz.

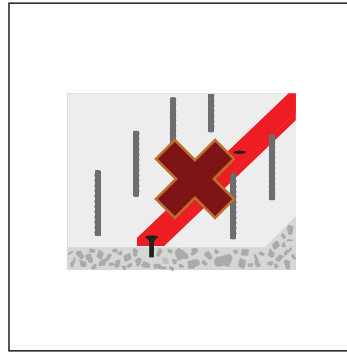

Mekanik sabitleme önerilmez.



EGECRETE

EGECRETE Yapı Kimyasalları A.Ş.
A licensee of EUCLID CHEMICAL

Merkez/Headquarters: Ayazma Cad. No: 37 Papirus Plaza Kat:10 Kağıthane 34406 İSTANBUL-TÜRKİYE Tel/Phone: +90 212 2946567
Fabrika-Depo/Plant-Warehouse: Asağı Kirazca Mah.Okul Sokak No:17 Arifiye 54580 SAKARYA-TÜRKİYE Tel/Phone: +90 264 2293200
satis@egecrete.com - www.egecrete.com